



EMERALD
WATERWAYS

Emerald Radiance Star-Ship

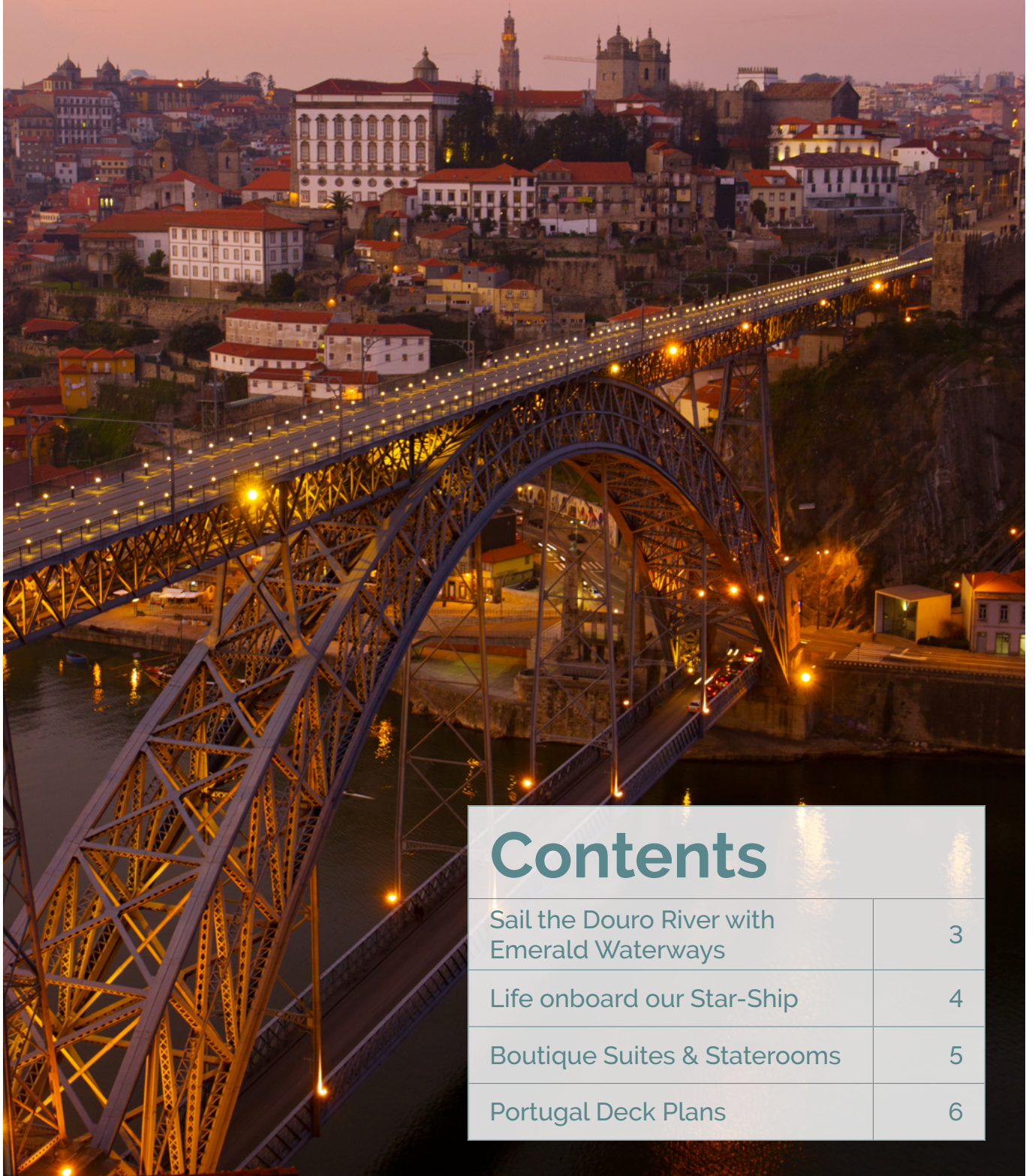

“The EmeraldPLUS six bridge illumination cruise through Porto on the first evening was delightful and set the tone perfectly for a wonderfully relaxing and enjoyable river cruise along the incredibly picturesque Douro River.”

– Emerald Waterways cruise expert Rebecca



Contents

Sail the Douro River with Emerald Waterways	3
Life onboard our Star-Ship	4
Boutique Suites & Staterooms	5
Portugal Deck Plans	6

Sail the Douro River with Emerald Waterways

The Douro River winds its way from Spain into Northern Portugal, an area almost lost in time, scattered with quaint villages, working family farms, and countless vineyards producing the specialties of the region.



The map shows the Douro River route starting in Salamanca, Spain, and flowing through Vega de Terrón, Pociinho, Régua, Pinhào, and ending in Porto, Portugal. The river is highlighted in a dark blue line with yellow circular markers at each stop. The countries Portugal and Spain are labeled in large, bold, teal letters.

Douro River

The Douro runs through one of Europe's most beautiful stretches of countryside, flanked by vineyards under the warming Portuguese sun. Traditional wineries and charming villages break up the fields of green which typify the Douro region.

- The Douro at 765 km long is one of the longest rivers of the Iberian Peninsula.
- Emerald Radiance, our most intimate Star-Ship in Europe to date, with a capacity of 112 guests sails the Iberian waters.



Life onboard our Star-Ship

Cutting a stylish and chic figure upon the rivers of Europe; Emerald Waterways' fleet of Star-Ships perfectly marry modern design with deluxe comfort for all guests. Honouring the beauty of some of the world's most aesthetically-stimulating waterways, each member of the fleet has been deliberately and responsibly designed to match and complement the eternal flow of the rivers.

Serenity Pool

The Emerald Radiance Star-Ship, sailing Portugal's Douro region, features a heated Serenity Pool on the Sun Deck, to make the most of the beautiful Portuguese sun as you sail.



Sun Deck

A panoramic rooftop space, home to a walking track, putting green and games area*, as well as deck chairs and sun-loungers, perfect for enjoying the spectacular scenery along Europe's most iconic rivers.



Horizon Bar & Lounge

The social heartbeat of our Star-Ships, comfortable and exceptionally modern, this haven is one of the most popular areas of our vessels. Enjoy local wines, beers, spirits, cocktails or a variety of teas and coffees whilst catching up with new-found friends in the relaxed setting. When the evening arrives, we have a medley of entertainment planned especially for you.



The Terrace

Situated at the front of the ship on the Horizon Deck, The Terrace boasts breath-taking views. Enjoy coffee and croissants for breakfast and a variety of local light bites for lunch as you watch areas of outstanding natural beauty pass by.



- Sun Deck
- Horizon Deck
- Vista Deck
- Riviera Deck



Welcoming Atrium

Low-hanging chandeliers and a glistening glass staircase, from the moment you step on-board you're surrounded by stylish, modern décor, every inch is designed with comfort and enjoyment in mind.



Fitness & Wellness Area

Our gym, complete with modern equipment suits those wanting to keep active during their time on-board. Wanting to unwind? A visit to our Wellness Area for a spa treatment is a must, indulge in a little 'me time' with a massage or facial.



Hairdressers

Book in with our on-board hairdressers for a new style or a beard trim, a lovely way to treat yourself ahead of a celebratory evening or the Captain's Gala Dinner.



Reflections Restaurant

Reflections Restaurant is the centre point of our on-board dining experience with a continuously evolving menu capturing seasonal and regional flavours to compliment your days ashore.

Begin your mornings with a hearty breakfast from the buffet offering hot and cold favourites. Following a morning of exploration is a delicious lunch back on-board, choose from regional delicacies, as well as many classics. Dinner is a celebration, enjoy an enticing buffet or à la carte menu with new friends while indulging in sumptuous dining in the most charming of settings.

Included with every lunch and dinner served on-board is a choice of wine, beer and soft drinks. Our wonderfully attentive team will always be on-hand to help you choose a drink to compliment your chosen meal.



*Please note facilities vary by Star-Ship.

Boutique Suites & Staterooms

Undeniably stylish suites & staterooms

Where comfort meets an innovative contemporary design our suites & staterooms are chic, modern sanctuaries. Boasting a wealth of sumptuous features, from luxurious toiletries and a revitalising shower in your spacious en-suite, to a queen size or twin hotel-style bed, draped with luxurious linens. In every cabin bottled water is replenished daily and with free Wi-Fi, a HDTV and infotainment system it's the ideal place to take some time out.

With a wide range of suites and staterooms available, we certainly have a cabin that is perfect for everyone. In all suites, a key feature is our ingenious all-weather system balcony, the perfect place to enjoy the endless river views regardless of the weather. Our staterooms offer a picture window, perfect for admiring the scenery.



Emerald Panorama Balcony Suite

Among the most spacious on Europe's waters, measuring between 160ft² to 188ft², we've put every effort into designing an elegant retreat for you to unwind in. Modern white and wood combinations create a tasteful and tranquil space for you to catch up on some reading, learn about the next destination on your itinerary, or watch a film on your HDTV. Sail past numerous points of outstanding beauty, soaking up every minute from your very own furnished all-weather balcony. This state-of-the-art feature is an inspired replacement allowing you to enjoy the feeling of sitting outside, close to the water and its banks, come rain or shine.

Owner's One-Bedroom Suite

The embodiment of luxury and spacious design, choose to stay in one of only two of these superior suites which measure at 285ft². You'll enjoy exceptional features—such as a separate living room and bedroom which closes off from the rest of the suite, a spacious bathroom, and a walk-in closet, allowing you to fully unwind and unpack. Enjoy a complimentary mini-bar, restocked daily, that's perfect for entertaining guests. You'll also enjoy several additional luxe touches and amenities, such as complimentary laundry service for four items a day; a Nespresso machine; and more. Plus, receive an invite to the Captain's table promises to be a memorable experience!



Emerald Riverview Suite

Located at the back of our Emerald Radiance ship, these two exclusive suites boast floor-to-ceiling windows and our innovative indoor balcony system for endless views at any time of day. Although the layout and size 300ft² of a Riverview Suite is unique, you will enjoy the same fantastic inclusions featured in our Owner's One-Bedroom Suite.

Emerald Stateroom

Located on the Riviera Deck, our staterooms are from 153ft² to 170ft², larger than the average standard stateroom on Europe's rivers. Picture windows are perfect for admiring the ever-changing views, while free Wi-Fi and HDTV and infotainment system, en-suite bathroom with revitalizing shower and luxurious toiletries mean you can transform this lovely space into your perfect home away from home.



Portugal deck plans

Emerald Radiance

- Built: 2017
- Length: 292ft (89m)
- Guests: 112
- Cabins: 56
- Crew Members: 37

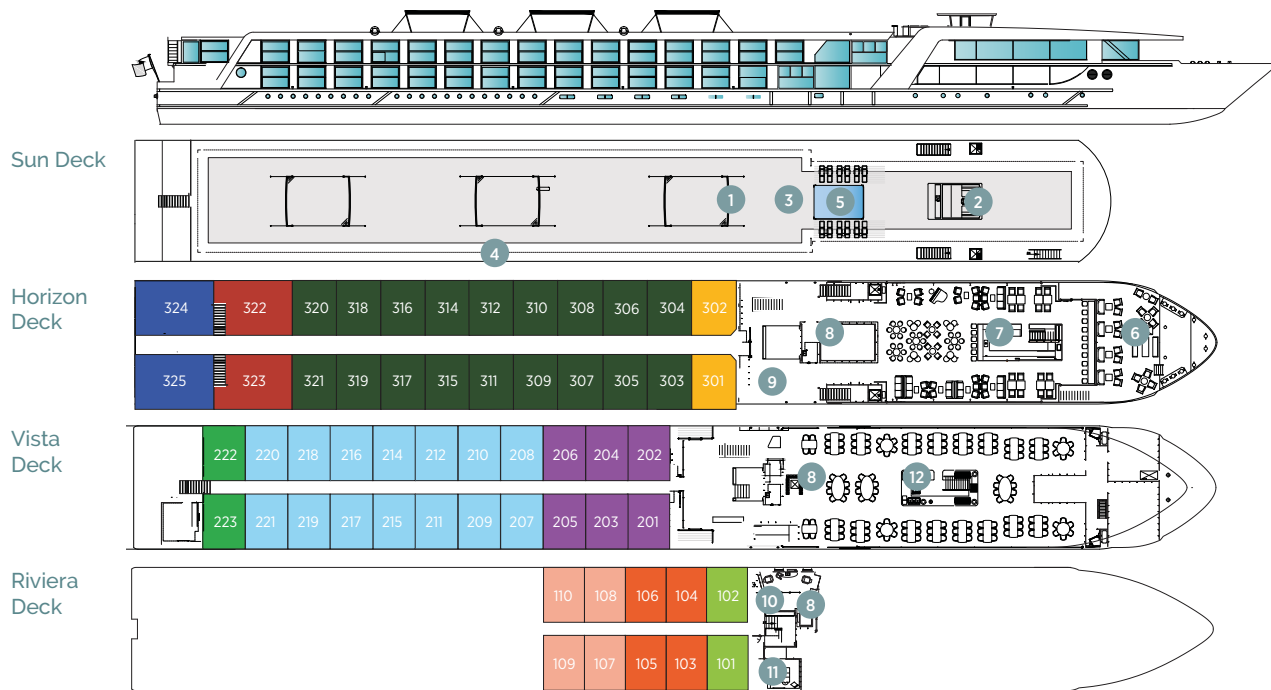

Cabin Categories		
Horizon Deck		Size ft ² (m ²)
CAT RA	Emerald Riverview Suite	300ft ² (27.9m ²)
CAT SA	Owner's One-Bedroom Suite	285ft ² (26.5m ²)
CAT P	Emerald Panorama Balcony Suite	170ft ² (15.8m ²)
CAT A	Emerald Panorama Balcony Suite	160ft ² (14.9m ²)
Vista Deck		Size ft ² (m ²)
CAT R	Emerald Panorama Balcony Suite	188ft ² (17.5m ²)
CAT B	Emerald Panorama Balcony Suite	160ft ² (14.9m ²)
CAT C	Emerald Panorama Balcony Suite	160ft ² (14.9m ²)
Riviera Deck		Size ft ² (m ²)
CAT D	Emerald Stateroom	170ft ² (15.8m ²)
CAT E	Emerald Stateroom	160ft ² (14.9m ²)
CAT F	Emerald Stateroom	153ft ² (14.3m ²)

- 1 Sun Deck with Deck Chairs[^]
- 2 Navigation Bridge
- 3 Sky Barbecue
- 4 Walking Track
- 5 Serenity Pool
- 6 The Terrace
- 7 Horizon Bar & Lounge
- 8 Elevator
- 9 Reception
- 10 Wellness Area/Hairdresser
- 11 Fitness Area
- 12 Reflections Restaurant

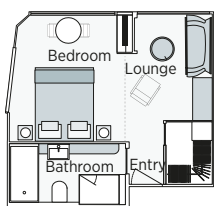

Emerald Riverview Suite
300ft² (27.9m²)
CAT RA

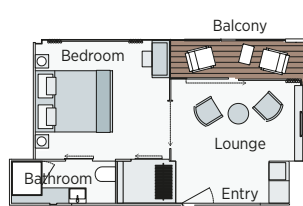

Owner's One-Bedroom Suite
285ft² (26.5m²)
CAT SA

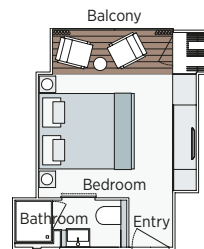

Emerald Panorama Balcony Suite
188ft² (17.5m²) - 160ft² (14.9m²)
CAT P CAT A CAT R CAT B CAT C

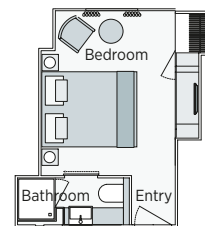

Emerald Stateroom
153ft² (14.3m²) - 170ft² (15.8²)
CAT D CAT E CAT F

Important Information: The cabin and deck plans, sizes and photographs are an indication only and are subject to variation.

[^] Due to safety, the Sun Deck will be closed when travelling under low bridges.