

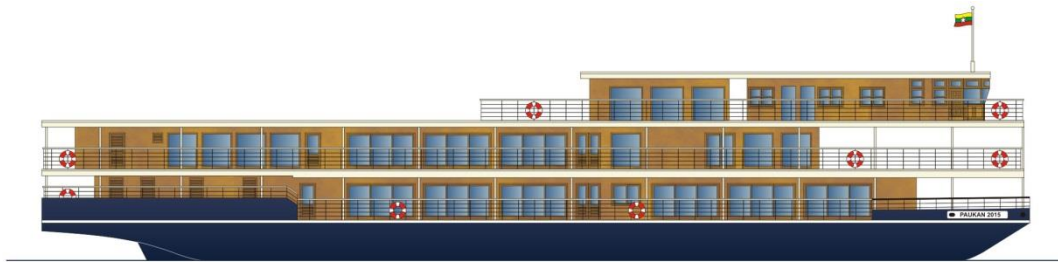

PAUKAN PRINCESSSM

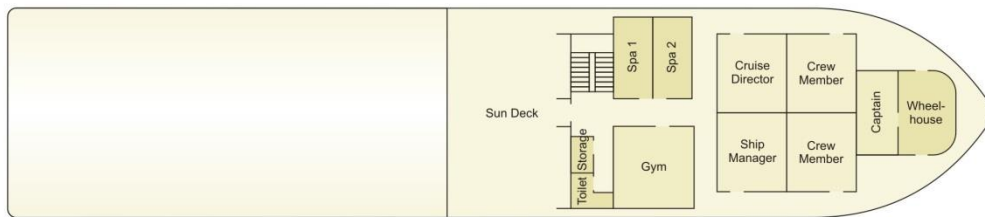

ELEVATION



SUN DECK

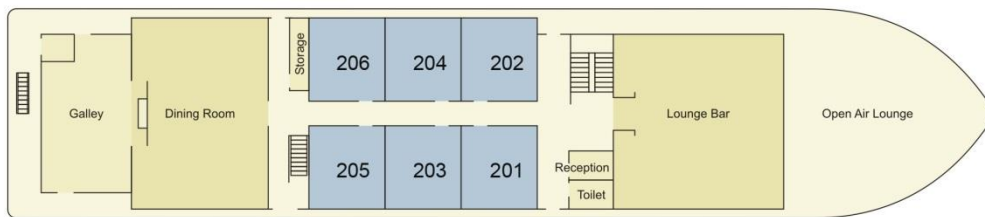

UPPER DECK

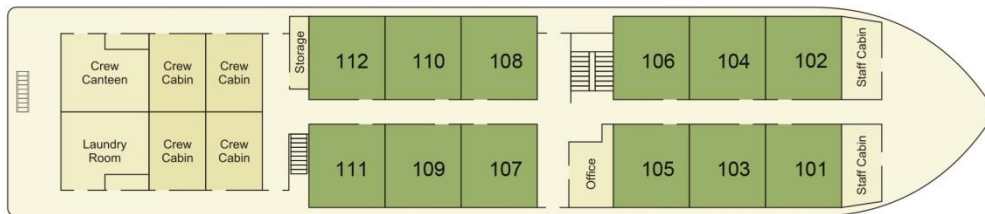

MAIN DECK

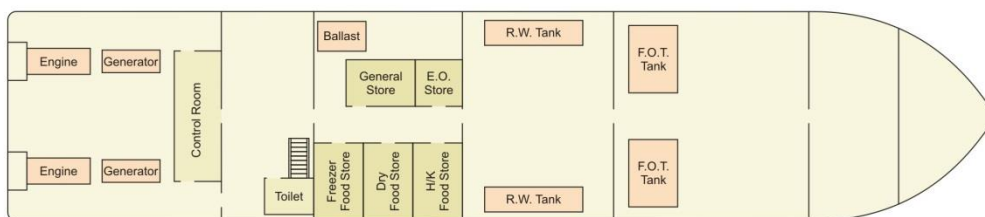

LOWER DECK

- Upper Deck Cabins
- Main Deck Cabins



Paukan Cruises

MANAGED BY AYRAVATA CRUISE COMPANY

PAUKAN PRINCESS



SPECIFICATIONS

BUILT IN THE 2015 BY AYRAVATA CRUISES AT MYANMAR SHIPYARDS (YANGON-MYANMAR)

HULL	MAINE STEEL
LENGTH	200 FT (61 MT)
BEAM	42 FT (12.8 MT)
DRAFT	3.9 FT (1.2 MT)
DECKS	3
DIESEL ENGINES	2 X 400 HP CUMMINS MARINE / MODEL NTA 855-M
PROPULSION	RUDDER PROPELLER INBOARD TRANSOM MOUNTED NAV 30
DESIGN SPEED	10 KNOTS
MAX. UPSTREAM SPEED	6.5 NAUTICAL MILES PER HOUR (DRY SEASON)
MAX. DOWNSTREAM SPEED	12 NAUTICAL MILES PER HOUR (DRY SEASON)
NAVIGATION	GPS, NAVIGATION, LIGHTS, SHIPS HORN, SEARCHLIGHT, SOUNDER
COMMUNICATION	VHF, GSM PHONE, INTERNAL PHONE SYSTEM, TANNOY FOR NAVIGATION
GENERATORS	2 X 312.5 KVA +1 X 80 KVA +1 X 50 KVA CUMMINS / STANFORD MARINE
FIRE PROTECTION	SMOKE DETECTORS, HEAT DETECTORS, MANUAL ALARMS STATIONS, FIRE EXTINGUISHERS, FIRE HOSE CABINETS
SAFETY	EMERGENCY LIGHTS, EMERGENCY EGNSET, SOLAS APPROVE LIFE JACKETS, LIFE RAFTS
CREW	30
PASSENGERS	36
CABINS	18 WITH PRIVATE BATHROOM <u>UPPER DECK</u> 6 STATEROOM WITH FRENCH BALCONY : 23 SQ.MT / 245 SQ. FT <u>MAIN DECK</u> 12 STATEROOM WITH FRENCH BALCONY : 23 SQ.MT / 245 SQ. FT. 2 STAFF CABINS (FOR LOCAL GUIDE / TOUR LEADER)
LOUNGE & BAR	ON THE UPPER DECK (40 SEATS INDOOR PANORAMA LOUNGE BAR & OPEN AIR LOUNGE)
DINING ROOM	ON THE UPPER DECK (CAPACITY : 36 SEATS)
SPA & GYM	ON THE SUN DECK : 2 SPA ROOMS * 1 GYM ROOM
SOLARIUM	ON SUN / ROOF DECK (CAPACITY : 8 SUN CHAIRS)
WATER	DESEDIMENTATION AND WATER TREATMENT SYSTEM – RESERVE OSMOSIS SYSTEM FOR THE KITCHEN / BAR



MANAGED BY AYRAVATA CRUISE COMPANY